

Axial bearing play measuring (turbocharger)

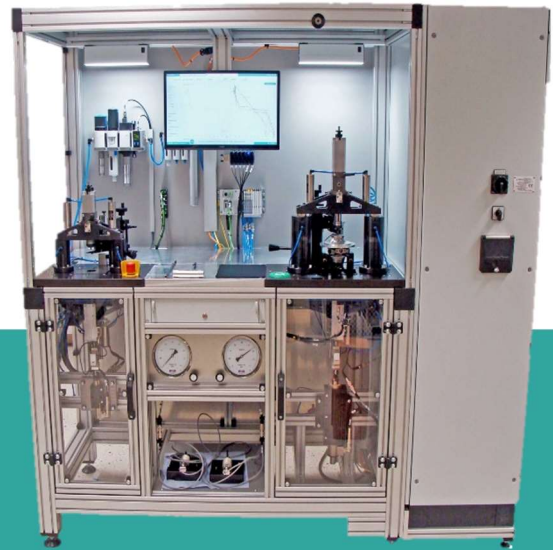

- Measuring system for the axial play of ball bearing mounted turbocharger assemblies under individual test conditions
- Measuring principle: Differential measurement via 2 measuring sensors directly on the test piece
- Can be operated manually
- Plotting of the force-displacement curves to differentiate the individual plays and breakaway forces
- Test force (tension, compression) and test speed can be parameterised freely
Test sequence can be combined freely
- Self-aligning clamping device
Repeat-accurate clamping ratios due to adjustable clamping force
Friction-free measuring assembly with air bearing guide and weight compensation
- Changing devices for different test pieces

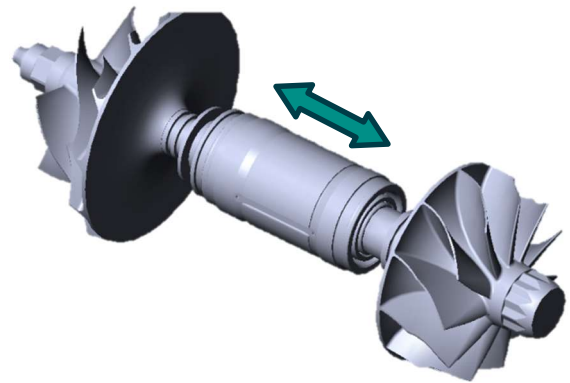

Technical Data

Test piece	Turbocharger assemblies, ball bearing mounted	
Measurable bearing play	3...100 µm	
Test force	±10...500 N	
Test force tolerance	±2 N	
Test duration	type-dependent, <1 min	
Clamping force for test piece	10...1000 N	
Measuring data processing and machine control		
Hardware	IPC	
Operating system	Windows	
Measuring data software	Premetric®	
Visualisation	Screen	
Storage	csv file	
Export	individual QA systems	
Electrical characteristic data	IEC	UL / CSA
Supply	400 V / 50 Hz / 16 A	480Y/277 VAC / 60 Hz / 16 A
Control voltage	24 V DC	24 V DC
Connected load	1 kVA	1 kVA
Compressed air connection	6 bar	
Airborne noise emission		
Maximum sound pressure level	<83 dB(A)	
Equivalent permanent noise level	<75 dB(A)	
Machine dimensions		
Width	2.1 m	
Depth	0.9 m	
Height	2.0 m	
Weight	approx. 700 kg	

